

International Partnerships

The Beuth University of Applied Sciences Berlin maintains contacts with a number of universities in Europe, and in South and North America. This is reflected in numerous collaborative projects and in particular, jointly undertaken design projects and workshops. Partner universities include those in Milan, Florence, Naples, Amsterdam, Copenhagen, Alicante, New York, Havana, Santiago de Chile and Rio de Janeiro. Student exchange programs with these universities are actively promoted.

International Workshop

„Exploring the public city“
Together with the Technical University of Delft, the Universidad de Alicante, Politechnika Krakowska and the Hogeschool van Amsterdam, the Beuth University of Applied Sciences Berlin, takes part in an annual international workshop with about 60 students whereas each participating university hosts events on a rotational basis. This urban planning project focuses on current problems in regard to public spaces of the respective host country

Research

The application-and practice-oriented research is carried out through cooperative projects and business-transfer activities, which provide an innovative research culture that gives a decisive impetus for a practical teaching methodology. The research projects are carried out partly in cooperation with international research institutions as well as with industry partners.

Impressum

Layout: Christoph König, Pressestelle
Text: Fachbereich IV
Redaktion: Pressestelle, Zentrale Studienberatung
Bilder: Fachbereich IV
Produktion: Fachbereich VI, Labor für Drucktechnik und Weiterverarbeitung
Änderungen vorbehalten! Stand: Februar 2010

Admission requirements

- A diploma or a bachelor's degree in architecture is prerequisite for admission to the master's program in architecture.
- Given the practical orientation of the master's studies program in architecture, work experience before the start of studies is strongly recommended.

Application Periods

For the following Winter Semester:

1st April until 15th July

For the following Summer Semester:

1st October until 15th January

Student Administration Office

Haus Grashof, rooms 133, 134, 136 und 138

Luxemburger Straße 10, 13353 Berlin

Telephone (030) 4504 - 2200

Telefax (030) 4504 - 2605

Internet www.beuth-hochschule.de/57

Opening Times

Monday 1.00 am – 4.00 pm

Tuesday 10.00 am – 1.00 pm

Wednesday 2.00 pm – 5.00 pm

Thursday 10.00 am – 1.00 pm

Central Student Guidance and Support Services

Haus Grashof, room 103

Luxemburger Straße 10, 13353 Berlin

Telephone (030) 4504 - 2020

Telefax (030) 4504 - 2720

E-Mail studienberatung@beuth-hochschule.de

Internet www.beuth-hochschule.de/33

Advice in Person

Monday 10.00 am – 12.00 noon

Wednesday 4.00 pm – 6.00 pm

Advice by Telephone

Tuesday 1.00 pm – 3.00 pm

Thursday 10.00 am – 12.00 noon

Departmental Student Guidance

Prof. Dr.-Ing. Susanne Junker

Haus Bauwesen, room 230

Telephone (030) 4504 - 2562

E-Mail suju@beuth-hochschule.de

More Informations:

www.beuth-hochschule.de/studiengaenge

How to find us

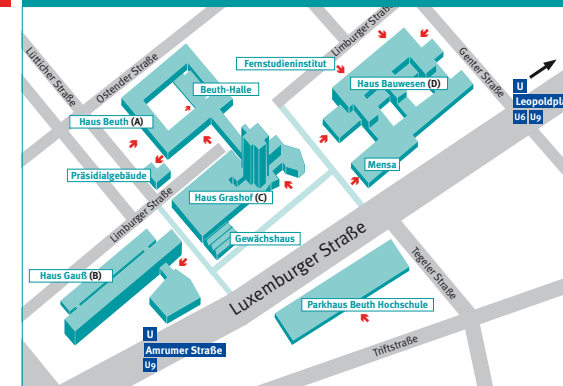

U-Bahn Linie U9, Amrumer Straße; U-Bahn Linie U6, Leopoldplatz

Department IV
Architecture and
Building Services Engineering



Master of Arts

Architecture

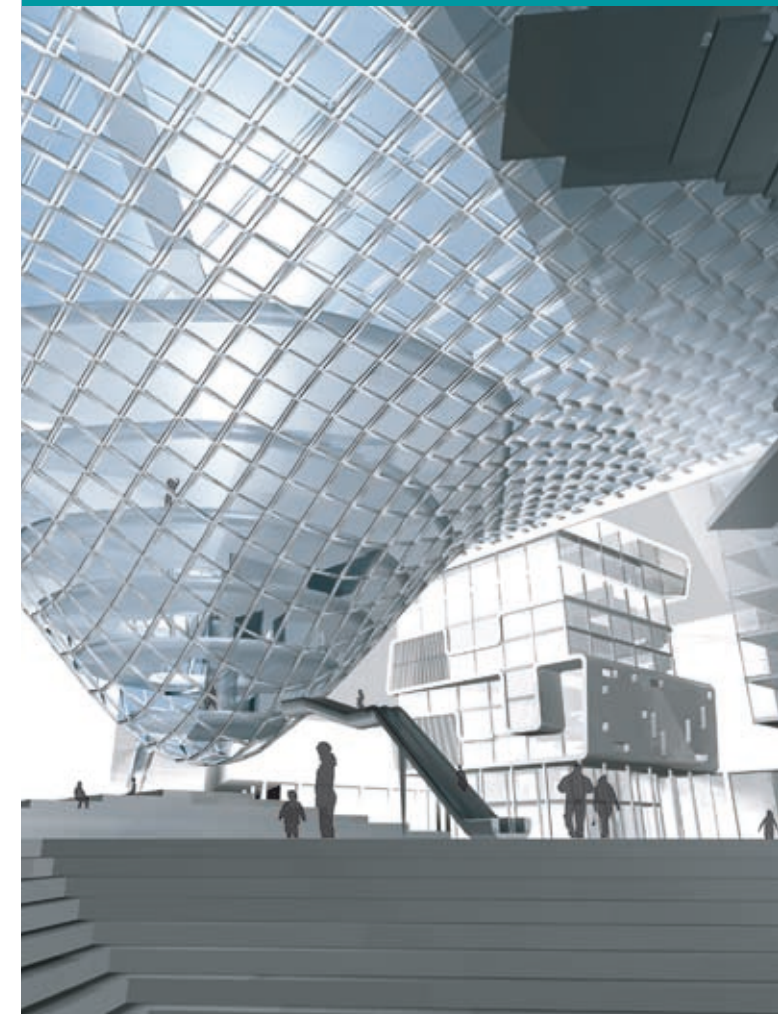

Beuth Hochschule für Technik Berlin



Career prospects

The career prospects in the architectural profession have changed greatly and expanded in recent years. Besides the traditional areas of design and construction, a number of further fields of activity have developed since the end of the 20th Century, such as: building revitalization, energy-efficient and sustainable building design, urban reconstruction, refurbishment, historical building preservation, building conversion, project management and controlling. The architect with the Master of Arts degree (in architecture) can actively intervene in the architectural-spatial environment by designing environments and implementing designs, concepts and analyses. As a creator, designer and coordinator, he represents the interface between the planning and executing agencies and the client.

After the student has been familiarized with the basics of architecture in the bachelor's program, the master's degree program leads further to academic development and specialization.

The master's degree in architecture represents the second stage of job skill acquisition in the architectural profession. This opens the way to professional, freelance work as an architect. But also in industry, in the construction sector, in state and municipal institutions, and in the areas of project and facility management there is a demand for well-trained architects.

The master's program qualifies for doctoral research in Germany and abroad. Appointment to a "higher grade of civil service" is possible.

Course contents

The master's program in architecture is application-oriented and offers the following core areas of study:

- Building revitalisation
 - building conservation and historic preservation
- Energy-efficient and sustainable building design
- Architecture and construction
 - design and urban planning

For individual specialization the following elective modules can be included:

- Planning and design
- Design and construction
- Design and technology
- Drawing and presentation
- Architectural history and building conservation
- Management and controlling

These areas of focus represent the architectural department's response to the new demands on the architectural profession. They are accompanied by instruction in media presentation and computer design techniques.

The program concludes with a master's thesis.

Practice

The master's degree program in architecture pays special attention to practical relevance, and continuously realigns instructional content to the constantly changing conditions of the architectural profession and its related occupational fields. This is reflected in the design and project development themes as well as a in the wide range of courses and seminars.

Our instructors come from a diverse number of construction and planning professions. Therefore, their broad range of expertise and problem-oriented issues and solutions add to and harmonize well with teaching content and methods. All potential aspects of future professional practice in various fields of discipline - individual work, teamwork and cooperative management - are therefore already part of the curriculum.

Duration and completion of studies

The prescribed period of study is four semesters (which includes the master's thesis) and leads to the Master of Arts degree (in architecture).

Summer academy

Since 2006, the Beuth University organizes the summer academy "ars berlin / sustainable architecture" with students from Beuth University and from various universities in the United States. „Ars berlin“ sees itself as a laboratory for visionary design, experimenting with architectural strategies for sustainable reorganization of urban space (www.summer-academy.architekten-tfh.de).

Degree course scheme

	Modul	Modulname	SU SWS	Ü SWS	Cr	P/ WP	FB
1. Semester	M1	Project 1: focus area					
		M1a Project 1 - Design of Buildings with Pre-determined Usage	1	2	5	P	IV
	M1b Project 1 - Urban Design and Planning						
	M2	History and Theory of Architecture	3	1	5	P	IV
	M3	Energy Conservation in Building	3	1	5	P	IV
	M4	Project Development and Project Management	3	1	5	P	IV
2. Semester	M5	Drawing and Presentation	3	1	5	P	IV
	M6	General Knowledge Supplementary Electives	2	2	5	WP	I
	Total ECTS		15	8	30		
	M7	Project 2: focus area					
		M7a Project 2 – Architecture/ Building Conservation	2	4	10	P	IV
	M7b Project 2 – Architecture/Design and Building Construction 1						
	M8	Construction Research and Diagnostics	3	1	5	P	IV
	M9	Elective Module - Planning and Design					
		M9a Design and Layout of Interior Spaces	2	3	5	WP	IV
	M9b Urban Design in Conurbation Areas						
M10	Elective Module - Design and Construction						
	M10a Experimental Drawing and Designing	2	3	5	WP	IV	
M10b Building Typology and Construction							
M11	Elective Module - History of Architecture and Building Conservation						
	M11a History and Theory of Architecture	2	3	5	WP	IV	
M11b Architecture History, Theory and Building Conservation							
Total ECTS		11	14	30			
3. Semester	M12	Project 3: focus area					
		M12a Project 3 – Architecture/Construction in Existing Buildings/Building Conservation	2	4	10	P	IV
	M12b Project 3 – Architecture/Design and Building Construction						
	M13	Development Trends in Structural Design	3	1	5	P	IV
	M14	Elective Module - Construction and Technology					
		M14a Historic Structures and Building Preservation	2	3	5	WP	IV
	M14b Climate-adapted and Sustainable Architecture						
	M15	Elective Module - Management und Controlling					
		M15a Cost Planning and Controlling	2	3	5	WP	IV
	M15b Risikomanagement						
M16	Elective Module - Drawing and Presentation						
	M16a Multi-Media Project Presentation	2	3	5	WP	IV	
M16b Experimental Design and Presentation							
Total ECTS		11	14	30			
4. Semester	M17	Master of Arts Thesis	0	0	25	P	IV
	M18	Master of Arts Final Examination	0	0	5	P	IV
	Total ECTS		0	0	30		

Abbreviations

SWS	hours per week	Cr	credits
SU	seminar	Ü	practice
P	required module	WP	elective module
FB	department		